

DLM-635-NL

RED LASERS: 635 nm, 100~800 mW



- Collimated Diode Lasers
- Easy use & maintenance free
- Longlife operation
- High efficiency
- High reliability

APPLICATIONS

- Laser show
- Display
- Laser Alignment
- Scanning Biochemistry
- Material Inspection LIDAR

SPECIFICATIONS

Wavelength	635 nm
Spatial Mode	Multimode
Output Power	100, 200, ..., 800 mW
Operation Mode	CW or Modulation
Modulation	Analog or TTL 0~30 kHz
Polarization	TM
Pointing Stability	<0.05 mrad
Beam Diameter (1/e ²)	<4 mm
Beam Divergence	<3 mrad
Power Stability	<±3% per 2 hrs
Temperature Stabilizing	TEC
Warm Up Time	<2 minutes
Expected Lifetime	5,000 hrs
Modulation	0~10 kHz
Laser Head Dimensions	40(W) × 100(L) × 50(H) mm (optional fan adds 15 mm height)
POWER SUPPLY	
OEM type EO-PS-I	58(W) × 100(L) × 32(H) mm AC/DC PSU: 85~265 V 50/60 Hz input
Lab type EO-PS-IIS	104(W) × 128(L) × 89(H) mm 85~265V 50/60 Hz input
Lab Adjustable type EO-PS-II	179(W) × 148(L) × 56(H) mm 85~265 V 50/60 Hz input

ORDERING INFORMATION

Catalogue number	Description
DLM-635-NL200	Output power 200 mW Beam Diameter 3,5 mm Beam Divergence 2 mrad
DLM-635-NL500	Output power 500 mW Beam Diameter 6 mm Beam Divergence 2 mrad
DLM-635-NL800	Output power 800 mW Beam Diameter 6 mm Beam Divergence 2 mrad
EO-PS-I	OEM Type power supply
EO-PS-IIS	Lab type power supply
EO-PS-II	Lab adjustable type power supply

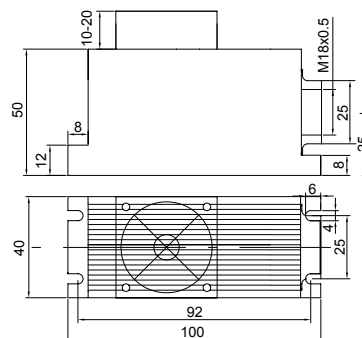

DLM-635-NL

POWER SUPPLIES

- OEM power supply **EO-PS-I**
- Lab type power supply **EO-PS-IIS**
- Lab adjustable type power supply **EO-PS-II**



RELATED PRODUCTS

Laser Safety Eyewear

See page 1.16.

